

26 Years Euregional Prize for Architecture

EAP26EAP
26EAP26E
AP26EAP2
6EAP26EA
P26EAP26
EAP26EAP

Kigamboni Performing Arts Centre

Participant info

Name: Daan Sillen
Institute: UHasselt

Project info

Can we use the wide variety of performing arts in Dar es Salaam, rooted in a long history of rural dance, music and storytelling, to activate new urban identities and initiate transition?

The aim is to empower creative talent by means of a culture production centre and by upgrading Dar's urban spaces into contemporary performance stages.

The centre offers spaces for cultural education, workshops and rehearsals. The wooden structure and the concept of its infill/enclosure, create a multifunctional toolbox to shape the centre according to its spatial flexibility, programmatic needs, financial opportunities and international ambitions.

In its innovative use of Tanzanian wood, being energy autarkic and low tech, this centre advocates sustainable building for Kigamboni.

The project can be developed in different stages and adapt to changing circumstances. Every phase opens new perspectives and interactions with its surroundings. The colourful shades and screens give the building its architectural expression and unique, changeable appearance.

Situated at the informal centre of Kigamboni, KCPA incorporates the pedestrian links and public places and transforms them into stages for its productions. The performers café is a place of interaction between local residents and artists, the rooftop terrace offers the visitor a spectacular view on the Kivukoni waterfront and Dar's cityscape. KCPA will be an urban place for physical activity and creativity, as well as an oasis of contemplation and recreation. By inviting artists of international renown, KCPA expresses its ambition to reach the highest standards of education in performing arts.

This spacious centre welcomes the visitors to be part of this cultural world of students, performers and dancers, in the exploration of their art.

KIGAMBONI PERFORMING ARTS CENTRE



COMMUNITY ENGAGEMENT
 In Kigamboni, the community is central to the creative spirit of its inhabitants rooted in Tanzania's long history of oral dance, music and storytelling.
 The project aims to empower that creative talent by means of a culture production center and by upgrading Kigamboni's urban spaces into contemporary performance stages.



KIGAMBONI
 It is the synergy between its inhabitants that forms the unique spatial identity of Kigamboni. With this project I want to visualize the positive impact of social density, drawing on the theoretical background of my dissertation on social inequality and its architectural appearance.



KPAC recognizes the pedestrian links and public places and transforms them into stages for its productions and invites the people who pass by to stop and to interact.

David Schmitt

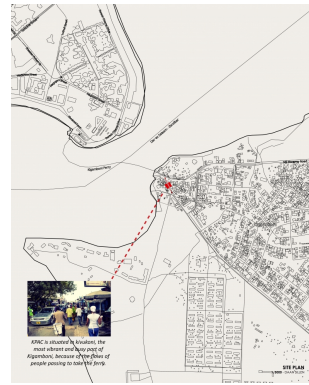

KPAC is situated in Kigamboni, the most vibrant and busy part of Kigamboni, because of the flow of people passing to and from the ferry.

SITE PLAN

2016

2025

2030



THE BUILDING - LOOK BEYOND THE STAGES OF CULTURE PRODUCTION | THE STREETS - LIVE

KPAC is a cultural production center whose mission is to create stages for the people of Kigamboni. It is a place where the creative talent of Kigamboni can express itself and flourish to reach the highest levels of production. With its open and flexible structure, the building can adapt to the needs of the community, as well as to the needs of the city and the region. The building is a series of interconnected volumes, which creates the highest standards of education in performing arts and become an urban hub for Kigamboni.

FLOOR PLANS 3 PHASES

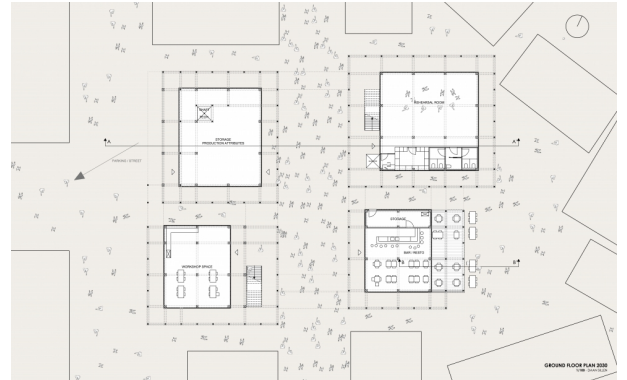

GROUND FLOOR PLAN 2025

2016



2025



2030



PERFORMANCE



VIEW FROM COURTYARD 2025

