

29 Years Euregional Prize for Architecture

EAP29EAP
29EAP29E
AP29EAP2
9EAP29EA
P29EAP29
EAP29EAP

Workbench ; The adaptive workplace

Participant info

Name: Arnaud Charoy
Institute: FH Aachen

Project info

Workbench
The adaptive workplace

This project define new offers to a well suited but abandoned place near the „chic“ streets from Maastricht (NL) inner city. A historic site between the Maas and the haven „het Bassin“ symbolise the confrontation of different fonctions. The aim of the project is to design a Work-Lab on this turning point.

Workbench define a space-princip, where the free „worktable“ in the middle of the room creates multiple scenarios of conections, space and fonctions but only if there is an action: the individual. The superior urban aim was to merge identity, history and creativ innovation in one place.

This for the form, interior and the facade was designed in memory to the industrial heritage of the place with some modern interpre-tation. The roof got an expressiv form with a big patio and detache itself from the rest of the building to response to an unique and new function.

The inner design devide itself in two parts. on the west, to the „bassin“ are placed big open coworking zones. The east side of the building is an interpretation of the impressiv historic cranes integrated in a vertical rack-structure with individual or group-boxes. This unique impuls of the boxes throug individuals are creating new spaces inbetween wich promote exchange, communication and creativity.

Tools as an intersection between the city and individuals.

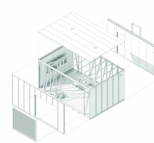

bas / subterranean structure

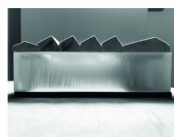

basement & light study



basement & subterranean

